

# Carburetor

## Idle Speed / Mixture

[KF with CATA]

### CO Meter Method

**⚠ WARNING** Do not smoke during this procedure.  
Keep any open flame away from your work area.

#### NOTE:

- Check that the self-diagnosis indicator before making idle speed and mixture inspections.

1. Start the engine and warm it up to normal operating temperature (the cooling fan comes twice).
2. Connect a tachometer.

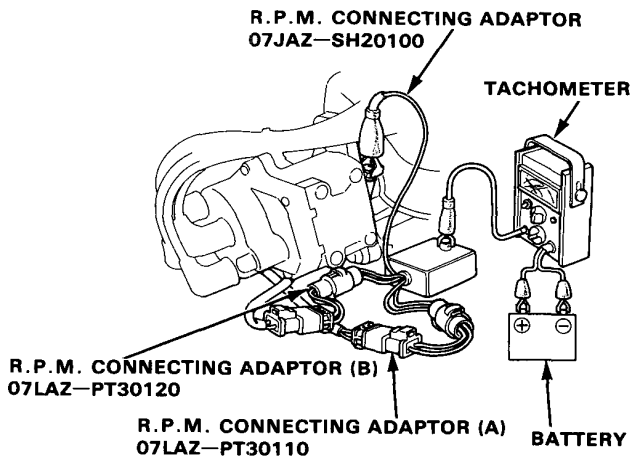

3. Turn the ignition switch OFF. Restart the engine and hold engine at idle for 2 minutes. And hold engine at 2,500—3,000 min<sup>-1</sup> (rpm) for 1 minute. Check idle speed with the headlights, heater blower, rear window defogger, cooling fan and air conditioner off.  
Idle speed should be: 800 ± 50 min<sup>-1</sup> (rpm)

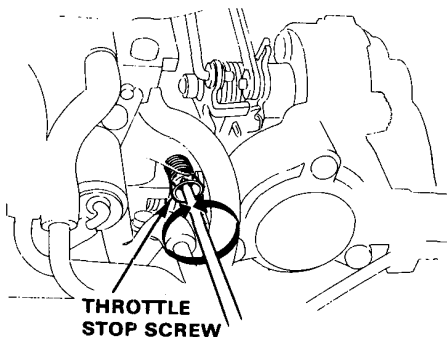

Adjust the idle speed, if necessary, by turning the throttle stop screw.

NOTE: If the idle speed is excessively high, check the throttle control system.

4. Calibrate the NDIR CO Meter in accordance with the manufacturer's recommended procedures. Insert exhaust gas sampling probe into the tailpipe at least 40 cm.
5. Turn the ignition switch OFF. Restart the engine and hold engine at idle for 2 minutes. And hold engine at 2,500—3,000 min<sup>-1</sup> (rpm) for 1 minute. Check specification for idle CO with cooling fan, air conditioner OFF and headlights OFF.

**Specified CO%: 0.1%**

- If idle CO is as specified, go to step 13.
- If not, go to step 6 through 12.

6. Disconnect the #2 vacuum hose from the carburetor, then cap the carburetor.

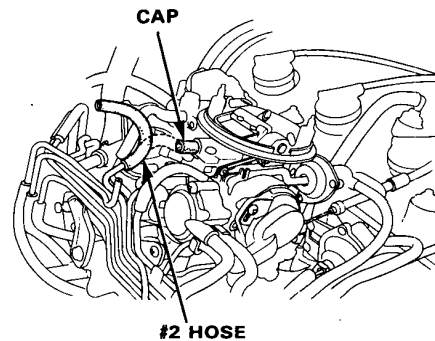

7. Disconnect the 2P connector from the EACV and disconnect the hose from the EACV, then cap the EACV.

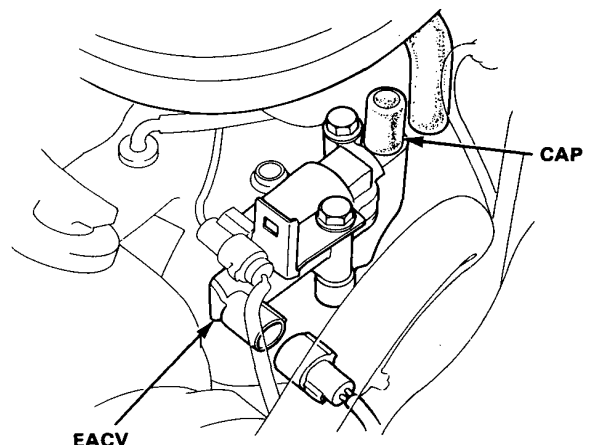



8. Disconnect the wire harness from the O<sup>2</sup> sensor.

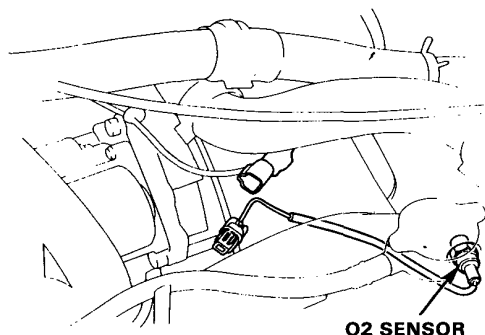

9. Turn the ignition switch OFF. Restart the engine and hold engine at idle for 2 minutes. And hold engine at 2,500–3,000 min<sup>-1</sup> (rpm) for 1 minute. Check specification for idle CO.

**Specified CO%: 2.5 ± 0.5%**

- If not, specification, go to step 10.

10. Remove mixture adjusting screw hole plug and adjust by turning mixture adjusting screw to obtain proper CO reading.

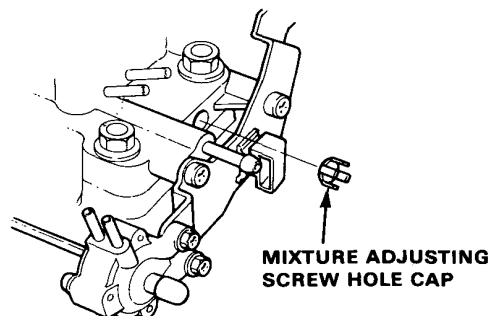

— Turning mixture adjusting screw

clockwise: CO reading decreases  
counterclockwise: CO reading increases

Readjust idle speed if necessary, and recheck idle CO.

11. Reconnect the connector and hose. Remove BACK UP fuse for 10 seconds to reset control unit.
12. Turn the ignition switch OFF. Restart the engine and hold engine at idle for 2 minutes. And hold engine at 2,500–3,000 min<sup>-1</sup> (rpm) for 1 minute. Recheck idle CO.

**Specified CO%: 0.1%**

- If idle CO is as specified, go to step 13.
- If not, check the self-diagnosis indicator (page 6-8). If not, inspect the EACV and the catalytic converter, then repeat step 6.

13. Recheck idle speed.  
**Idle speed should be: 800 ± 50 min<sup>-1</sup> (rpm)**

(cont'd)

# Carburetor

## Idle Speed/Mixture (cont'd)

- If idle speed is as specified, go to step 14.
- If idle speed is not as specified, adjust by turning throttle stop screw, then repeat step 5.

14. Reinstall the mixture adjusting screw hole cap.

15. Disconnect the connector on the P/S oil pressure switch.

P/S OIL PRESSURE SWITCH

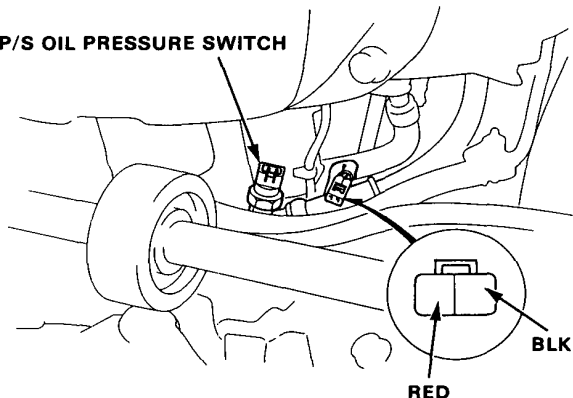

16. Check the idle speed.

Idle speed should be:  $950 \pm 50 \text{ min}^{-1} \text{ (rpm)}$

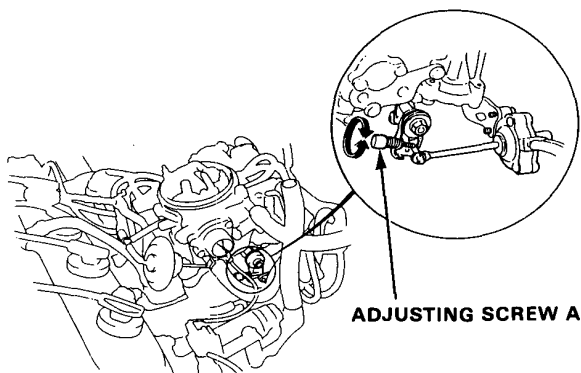

Adjust the idle speed, if necessary, by turning the adjusting screw A.

17. If equipped with air conditioner, check the idle speed with the A/C on.

Idle speed should be:  $800 \pm 50 \text{ min}^{-1} \text{ (rpm)}$

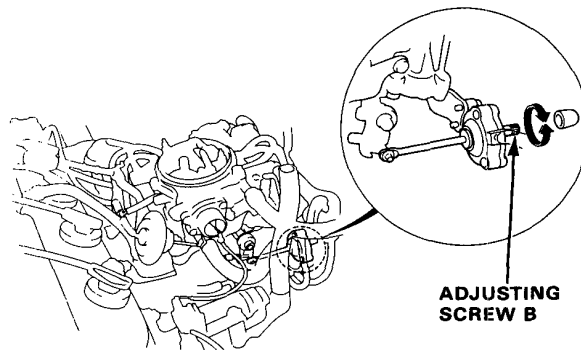

Adjust the idle speed, if necessary, by turning the adjusting screw B.



# Emission Control System

## Tailpipe Emissions

### Inspection

NOTE: It is not possible to use a CO meter to adjust the idle mixture; the effect of the catalytic converter prevents accurate tracking of such small changes in air-fuel ratio.

**⚠ WARNING** Do not smoke during this procedure. Keep any open flame away from your work area.

1. Warm up and calibrate the CO meter according to the meter manufacturer's instructions.
2. Start the engine and warm it up to normal operating temperature (the cooling fan comes on twice).
3. Turn the ignition switch OFF. Restart the engine and hold engine at idle for 2 minutes.  
And hold engine at 2,500—3,000  $\text{min}^{-1}$  (rpm) for 1 minute.
4. Check idle CO with the headlights, heater blower, rear window defogger, cooling fan, and air conditioner off.

**Specified CO %: below 0.1%**